

## More Affordable & Improved / Simplified Calibration

- **Tabs • Drives • Jackplates • Fuel Level •**
- **Water Level • Rudder Indicators •**



- Compatible with NMEA 2000® , SmartCraft® with gateway
- Simple plug and play installation, eliminates clumsy mechanical cables
- No cables means, no loss of motion
- All electronics are completely sealed
- Indication Options Include:
  - Fill bar type- multiple LEDs lit in a row
  - Pointer type - one LED pointer displays your position/level
- 17 LED lights per slot with a red LED warning light located at the bottom of the slot, which can be used as a warning for resistive type or digital switch senders
- The green LED in the center may be calibrated to show optimal level position (sweet spot) for Drives, Tabs, etc
- Readable in direct sunlight even with polarized sunglasses
- Built-in photo sensor automatically adjusts to ambient light with 250 brightness intensity levels
- Has the ability to compensate for non-linear tanks giving you accurate readings
- 0-5 volt or resistive type sensors (ohm) (adjustable) and NMEA 2000
- 1 to 4 slot configurations, vertical or horizontal with 17 LED's for superior resolution
- Input supply voltage of 12 VDC only with reverse polarity protection
- Indicators are available in a variety of colors to match your Livorsi gauges and accessories
- Easy calibration
- Available in manual dimable/blackout or automatic

**Each slot accommodates two analog inputs**

Inputs accepted are either 0-5 volts or resistive sensors. These inputs can be transmitted or received from the SmartCraft® (with gateway) or NMEA 2000® network straight into your Garmin, Lowrance, Raymarine or other LED display.

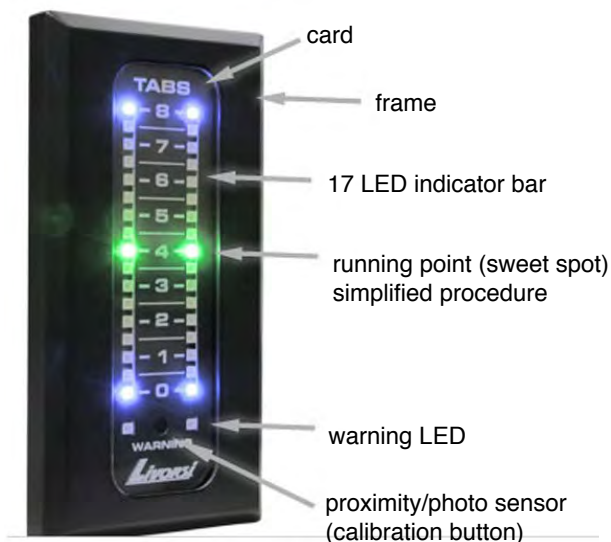

**NMEA2000 Certified**

**Voltage or Resistance Sensors**

Tabs, drives, jack plates, fuel level, water level and rudder indicator applications must have a resistance or voltage type sensor present for this system to operate. Below are some of the options.

Mechanical to Electric Converter 0-5 Volts  
(cable not included)

Converts the mechanical signal to an electric signal. Bolts on the inside of the transom with a short cable to the unit.



Price \$150

Mounted pot on Mercury trim tab 0-5 Volts

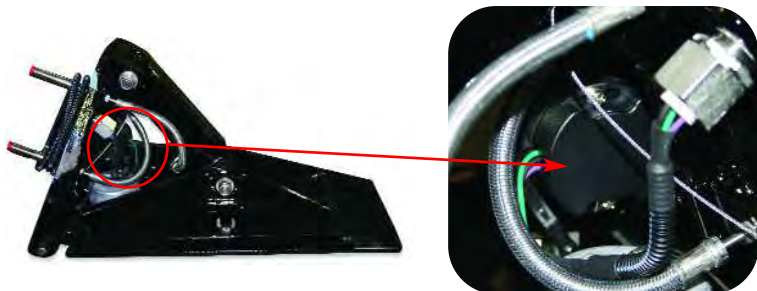

Tabs 2010 or newer should contain the 5 volt sensor  
Tabs 2006-2010 model #'s 280S and 380S should have a bracket to add the sensor

See page10 for a list of sensor components

Mercury trim tab sensor  
Part Number: MTT280  
Price: \$349.00

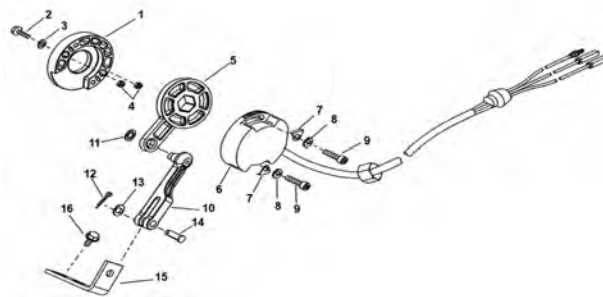

@98`bX]WUrcf`6i ]X`G\YYh!`f5bU`c[ `cf`F Yg]ghj Y`&`cf`" `K ]fY`GYbXYfgk

**POSITION:**

Number of LED rows. 1 \_\_\_ 2 \_\_\_ 3 \_\_\_ 4 \_\_\_

Available functions. Analog (Standalone systems)

Row 1 \_\_\_ Trim tabs \_\_\_ Drive / Outboard trim \_\_\_ Rudder \_\_\_ Jack plate \_\_\_ Other \_\_\_

Row 2 \_\_\_ Trim tabs \_\_\_ Drive / Outboard trim \_\_\_ Rudder \_\_\_ Jack plate \_\_\_ Other \_\_\_

Row 3 \_\_\_ Trim tabs \_\_\_ Drive / Outboard trim \_\_\_ Rudder \_\_\_ Jack plate \_\_\_ Other \_\_\_

Row 4 \_\_\_ Trim tabs \_\_\_ Drive / Outboard trim \_\_\_ Rudder \_\_\_ Jack plate \_\_\_ Other \_\_\_

Equipped with (Choose one)

\_\_\_ 2 Wire resistive senders \_\_\_ 3 Wire Voltage senders

\_\_\_ No sender will require CBME5VD-000020 Converter box. Cable length... 2...3...4...5

: @ -8`@9J 9@

Number of LED rows. 1 \_\_\_ 2 \_\_\_ 3 \_\_\_ 4 \_\_\_

Available functions. Analog (Standalone systems)

Row 1 \_\_\_ Fresh Water \_\_\_ Grey Water \_\_\_ Oil \_\_\_ Other \_\_\_

Row 2 \_\_\_ Fresh Water \_\_\_ Grey Water \_\_\_ Oil \_\_\_ Other \_\_\_

Row 3 \_\_\_ Fresh Water \_\_\_ Grey Water \_\_\_ Oil \_\_\_ Other \_\_\_

Row 4 \_\_\_ Fresh Water \_\_\_ Grey Water \_\_\_ Oil \_\_\_ Other \_\_\_

Equipped with (Choose one)

\_\_\_ 2 Wire resistive senders \_\_\_ 3 Wire Voltage senders

**BOAT:**

Make & Year \_\_\_\_\_

Length \_\_\_\_\_

Beam \_\_\_\_\_

Dual Station \_\_\_\_\_

Engine Manufacture \_\_\_\_\_

Number of Motors \_\_\_\_\_

Trim Tab Manufacture \_\_\_\_\_

Name \_\_\_\_\_

Phone \_\_\_\_\_

## Building Your Indicator Part Number

		FIRST ITEM DATA	SECOND ITEM DATA	CARD COLOR	FRAME COLOR
		1 or 2 slot	3 or 4 slot		
Part Number	ALEDI	2D	2T	PL	CH
		1 Drive = 1D 2 Drives = 2D  1 Tab = 1T 2 Tabs = 2T  1 Fuel = 1F 2 Fuel = 2F 1 Jack Plate = 1J 2 Jack Plate = 2J 1 Rudder = 1R 2 Rudder = 2R	1 Drive = 1D 2 Drives = 2D 3 Drives = 3D 4 Drives = 4D  1 Tab = 1T 2 Tabs = 2T 3 Tabs = 3T 4 Tabs = 4T  1 Fuel = 1F 2 Fuel = 2F 1 Jack Plate = 1J 2 Jack Plate = 2J	Platinum = PL Carbon Fiber = CF Silver Fiber = SF White = W Black = BK	Platinum = PL White = W Black = BK Blue = BL Mustard = MU Red = R Orange = O Lime = L Purple = PU Chrome = CH
ALEDI2D2TPLCH					

### Examples of Vertical Layouts

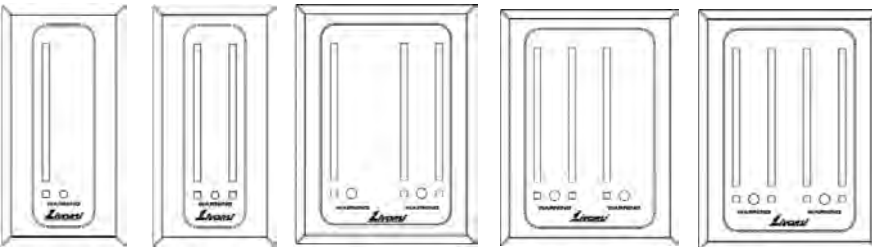

### Examples of Horizontal Layouts

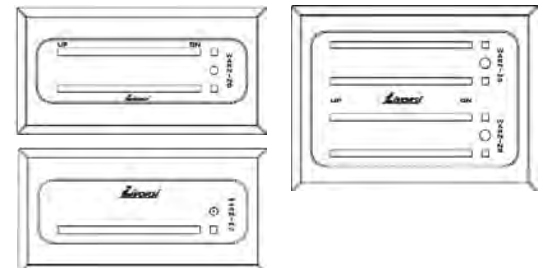

### Color Options



### Dimensions and Power Supply

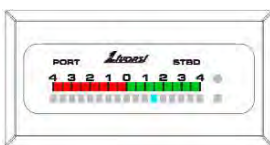

1 or 2 slot

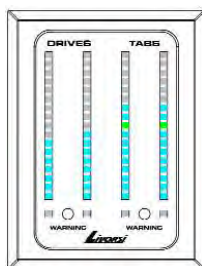

3 or 4 slot

#### Dimensions

1 or 2 slot indicator:  
 2 5/8" W x 5 3/16" H overall  
 requires (2) 1-1/4" cutouts for wiring

3 or 4 slot indicator:  
 4 1/16" W x 5 7/16" H overall  
 requires (4) 1-1/4" cutouts for wiring

#### Power Supply

Input supply voltage of 12 VDC,  
 with reverse polarity protection

## Indicator List Price

Description	List Price
1 slot	\$500.00
2 slot	\$592.00
3 slot	\$900.00
4 slot	\$1,000.00

## Harness

Harness Options	Part Number	List Price
<b>Main Harness to Jumper Harness</b>		
N2K Only	LEDHNM30	\$52.58
Main Harness 20 feet	LEDHSA20	\$88.37
Main Harness 25 feet	LEDHSA25	\$96.12
Main Harness 30 feet	LEDHSA30	\$105.42
Main Harness 40 feet	LEDHSA40	\$111.62
<b>Jumper Harness to Sensor Input</b>		
Tab/Drive/Fuel Jumper Single 5 feet	LEDHEXTS	\$25.98
Center Console Harness	LEDHEXTY8	\$70.38
Tabs/Drives/Fuel Jumper Dual 10 feet	LEDHEXT10	\$48.74
Tabs/Drives/Fuel Jumper Dual 15 feet	LEDHEXT15	\$56.59
Mercury SmartCraft® Drive Jumper Single 5 feet	LEDHYS	\$42.12
Mercury SmartCraft® Drive Jumper Dual (Dual) 5 feet	LEDHYD5	\$65.18
Mercury SmartCraft® Drive Jumper Dual (Dual) 10 feet	LEDHYD10	\$71.22
Mercury SmartCraft® Drive Jumper Dual (Dual) 15 feet	LEDHYD15	\$82.12
Mechanical to Electric Converter 0-5 Volts	CBME5VD-000020	\$150.00
Mercury trim tab sensor	MTTS280	\$349.00

## Cables for Mechanical to Electric Converter (33 Series Cables)

Description	Part Number	List Price
3 ft	CA3	\$33.00
4 ft	CA4	\$33.00
5 ft	CA5	\$33.00
6 ft	CA6	\$33.00

NOTE: Before ordering your Mercury SmartCraft® Drive Jumper harness, first verify which type of drive sensor you have: the 3-wire 0-5 volt sensor or the 2-wire resistive sensor.

### For more information please contact one of our sales reps:

Marty Alexonis  
martya@livorsi.com  
847.752.2706

Fred Ortega  
fredo@livorsi.com  
847.752.2705

Tom Veronneau  
West Coast Sales Rep  
tomv@comp.com  
951.323.9756

Mike Livorsi  
mikel@livorsi.com  
847.752.2710

**SAE J1939**

