

OUTBOARD BACKING PLATES

FEATURES:

- Available in 2 hole & 4 hole Anodized Aluminum or 316 Stainless Steel for complete saltwater protection
- Evenly distributes stress throughout transom area
- With or without Logo (Private Labeling Available)
- One-time art charge
- Available in many colors

PART NUMBERS



MP1	Small Plate - 2 Hole
Base PN	
MP-1ALCAN	Clear Anodized AL
MP-1AL-L01W	Lasered Logo
MP-1SS	316 Stainless
MP-1SS-B01	316 Stainless + Logo
MP2	Large Plate - 4 Hole
MP-2ALCAN	Clear Anodized AL
MP-2AL-L01W	Lasered Logo
MP-2SS	316 Stainless
MP-2SS-B01	316 Stainless + Logo
MP3	Large Plate - 4 Hole - 3.13" Width
MP-3ALCAN	Clear Anodized AL
MP-3AL-L01W	Lasered Logo
MP-3SS	316 Stainless
MP-3SS-B01	316 Stainless + Logo
MP4	S-Plate 4 - Hole
MP-4ALCAN	Clear Anodized AL
MP5	Lower Deck Plate 2 - Hole
MP-5SS	Anodized AL

OB BACKING PLATES

MP1SS

316 Stainless Steel

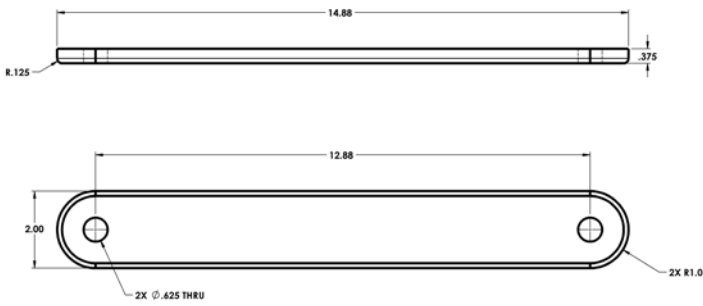

Anodized Aluminum

MP2AL

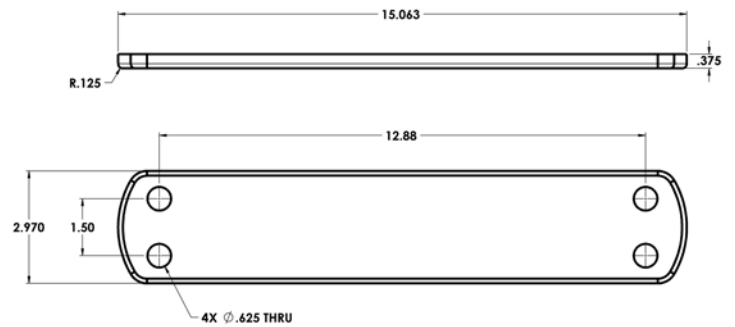

OVERSIZED

- Oversized backing plate for Mercury 450 R engines & other large HP engines



Increased Width
MP3SS

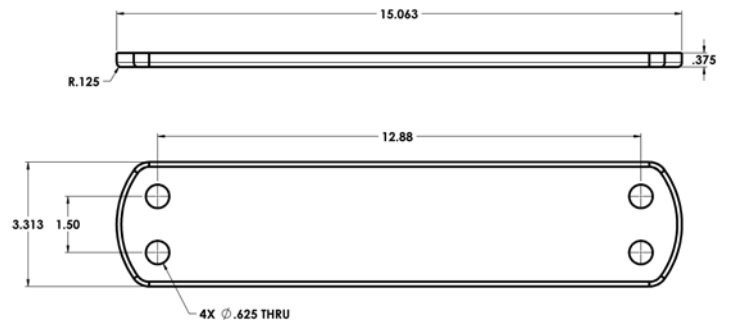

S-PLATES

- Backing plates for OB when mounting below deck & stringers are in the way

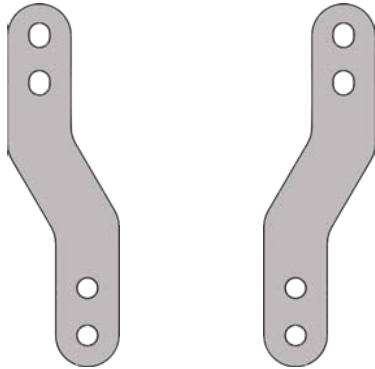

MP4SS

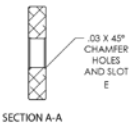
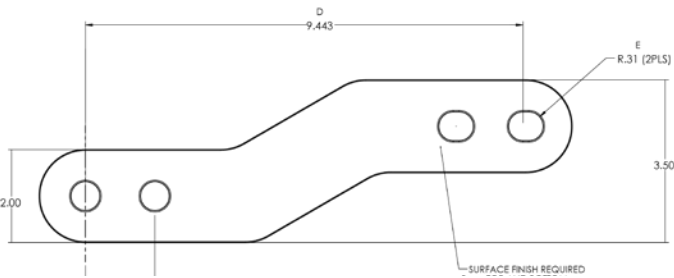
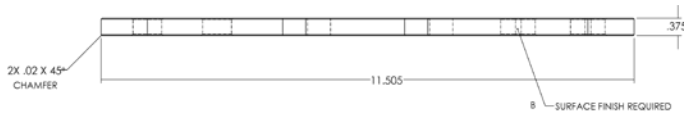

OB Below Deck S-Plate

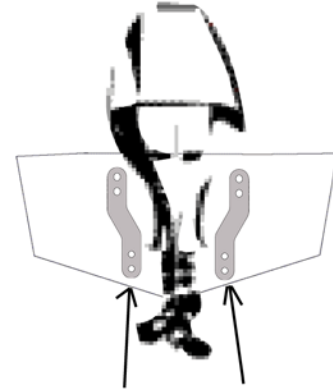

***Unlike Washers, these plates distribute load evenly across the transom**

LOWER MOUNTING PLATES

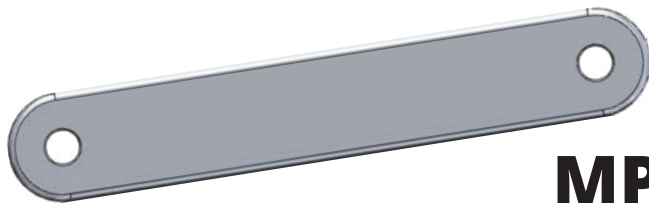

MP5SS

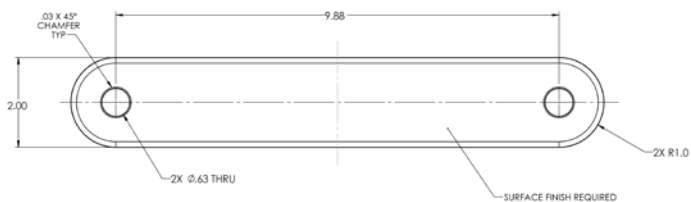

OB Below Deck Plate

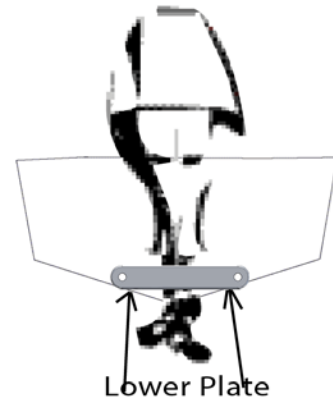

***Unlike Washers, these plates distribute load evenly across the transom**

NEW!

HIGH FLOW FUEL / WATER SEPARATORS

Single Tank

(2 PORT)



Dual Tank

(4 PORT)

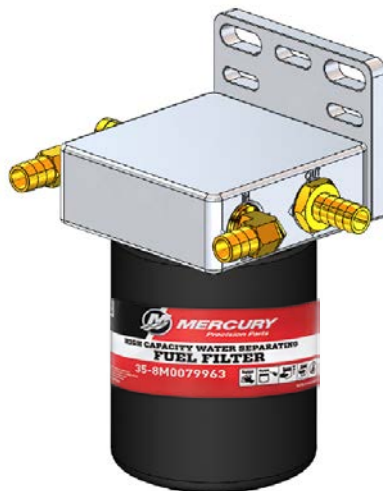

Triple Tank

(6 PORT)



- Compatible with Mercury's new 450R & other high horsepower engines
- Multiple Port locations allow units to be mounted almost anywhere
- Configurable mounting bracket allows installers to mount fuel/water separators in tight locations
- Anodized and painted for superior corrosion resistance
- 1/2" or 3/8" NPT fittings available