

## ADJUSTABLE LED INDICATOR INSTALLATION

WITH THE USE OF A MERCURY® MERCMONITOR

**IMPORTANT:** The NMEA power harness adapter should be utilized when integrating the MercMonitor with a NMEA 2000/J1939 communication that does not have an existing NMEA 2000 backbone installed.

**IMPORTANT:** The NMEA 3 amp fuse must be utilized when integrating the MercMonitor with a NMEA 2000/J1939 communication that does not have an existing NMEA 2000 backbone installed.

**NOTE:** Any NMEA 2000 device (chart plotter, radar, GPS, ALEDI) can be connected to the T-connector.

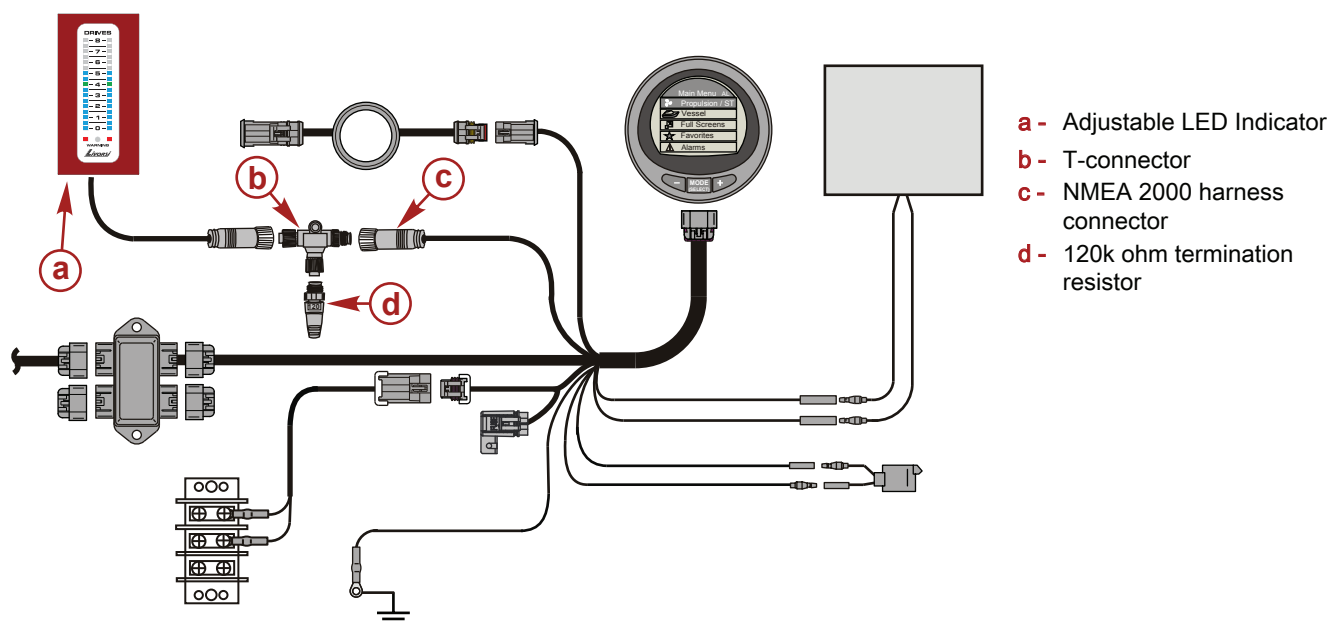

**IMPORTANT:** When more than one NMEA 2000 device is interfaced with a NMEA 2000 backbone, a 120k ohm termination resistor must be installed at each end of the NMEA backbone. The second 120k ohm termination resistor is not supplied with the kit. Please contact us to purchase.

